

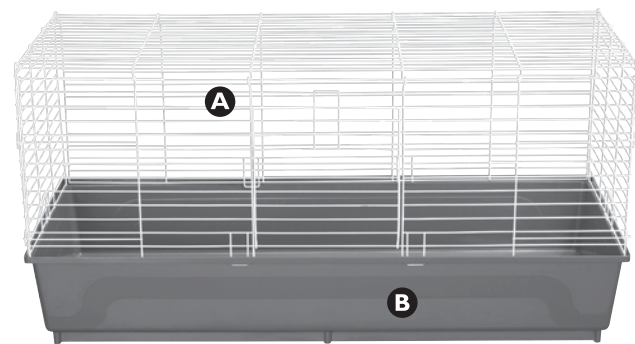

My First Home Extra Large Assembly Instructions

DESCRIPTION	MATERIAL NO.	UPC
MFH Extra Large 42"x18" Habitat	100509298	045125502305
MFH Extra Large Unassembled	100037818	045125602395
MFH Complete Kit Rabbit 42"x18"	100520311	045125601572



Important:

Carefully Unpack and Sort All Components on the Parts List

QTY.	KEY	DESCRIPTION
1	A	Wire Panel Set, White
1	B	Plastic Base

If your new pet home has experienced damage during shipping, please do not return your cage to the store.

Our Customer Service Department is available to help with any problems. Our Toll-Free Number (within the USA and Canada only) is 800-255-4527, Monday - Friday from 8:00 a.m. to 4:00 p.m. (Central Standard Time).

SAVE YOUR INSTRUCTIONS FOR FUTURE REFERENCE

Manufactured by: KAYTEE Products, Inc., Chilton, WI 53014 USA

©2016, 2018 KAYTEE Products, Inc.

Made in the USA of US and Imported Parts

Kaytee and Kaytee with design are registered trademarks of Kaytee Products, Inc.

For more information on bird and small animal products,

visit us at: kaytee.com

PP1004416

STEP 1 Unwrap Wire Panels

Unwrap the Wire Panel Set (A) and lay on a flat surface with the doorway opening facing upward.

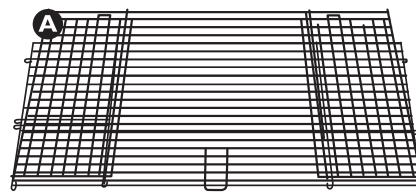

STEP 2 Unfold Wire Panel Set

Carefully unfold the Front, Back, and Side Panels.

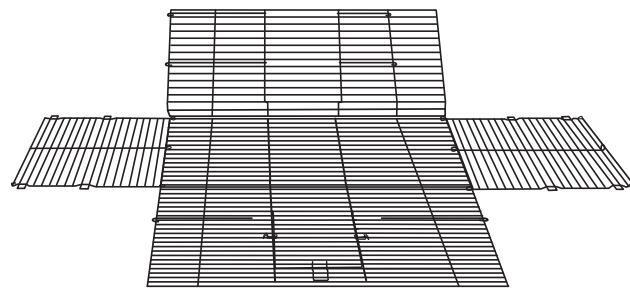

STEP 3 Lock Side Panels to Back Panel

Lock the Right and Left Side Panels onto the Back Panel.

Snap the Wire Hook through the Wire Loop.

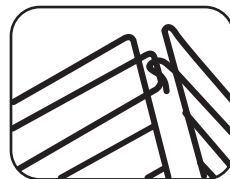
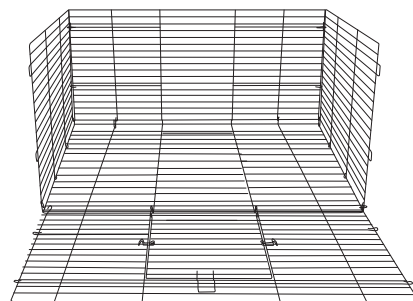

STEP 4 Lock Front Panel to Side Panels

Lock the Front Panel onto the Side Panels.

Special Note: If the wire hooks have become bent during shipping, carefully pry them open to fit into the side panel wire loops.

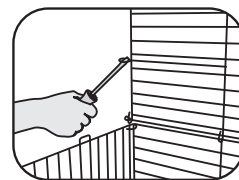

STEP 5 Lock Wire Panels into Base

Flip the wire cage over, place on top of the Plastic Base (B) and slide the wire under the attachment tabs.

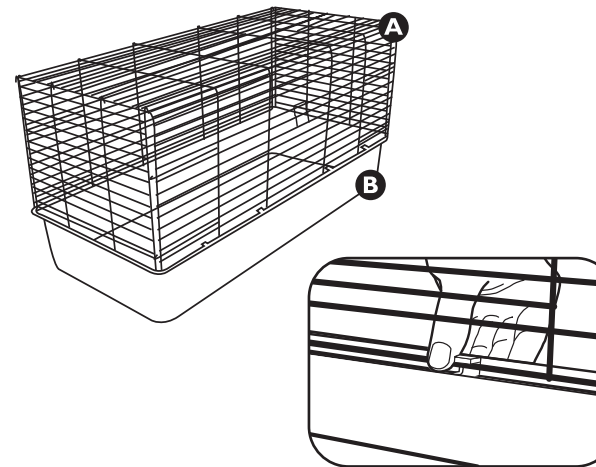

STEP 6 Secure Wire to Base

Line up the loops at the bottom of the Wire Panel to the holes provided on the Plastic Base.

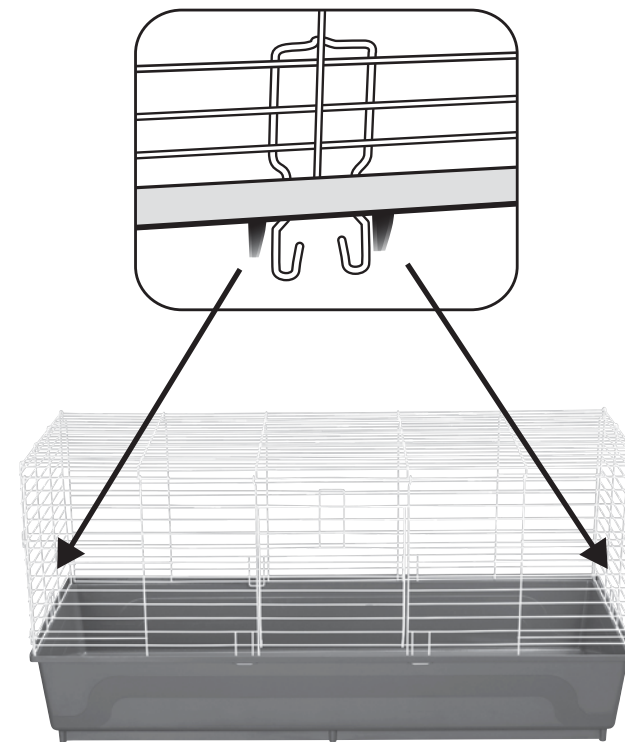

SAFETY

To safely secure your pet inside the home, firmly press the "Z-Lock" Latch behind the 2nd horizontal cage bar above the door opening.

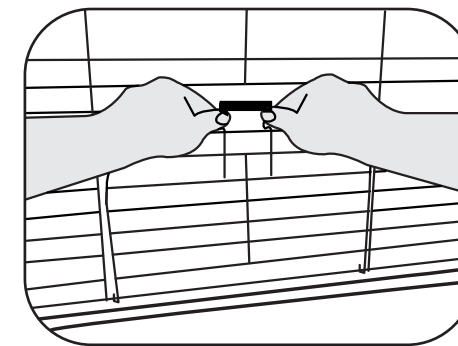

CLEANING

To clean your pet's home simply pinch the bunny ear latches on each side of the Cage Wire Set to remove from the Base. Empty and wash the plastic base or spray with Kaytee® Clean Cage Spray (Item #100079553), wipe dry, refill with fresh bedding material, and replace the wire top onto the Plastic Base. Kaytee® Clean Cage neutralizes odors, safely cleans surfaces, and is non-toxic to all pets.

